



## **PITCHED ROOF SOLUTIONS**

Insulation, Airtightness & Moisture  
Management Solutions for Timber Frame  
Roof Structures

# CONTENTS

|  |    |
|--|----|
| Introduction .....                                   | 3  |
| Standards and Certification .....                    | 4  |
| Control of Condensation and Ventilation.....         | 5  |
| Building Regulations .....                           | 6  |
| Fire Performance .....                               | 8  |
| Pitched Roofs .....                                  | 10 |
| Pitched Roof with Internal Counter Battens.....      | 12 |
| Installation Pitched Roof with Counter Battens ..... | 14 |
| Isover Metac Roll 031 .....                          | 16 |
| Isover Metac Roll 034 .....                          | 17 |



# PITCHED ROOF APPLICATION ISOVER METAC & VARIO® SYSTEM

Isover offers one of the safest options for insulating Pitched Roofs, both in New Build and Renovation projects.

Isover Metac is a high performance mineral wool insulation 'slab on a roll'. When used in conjunction with our Vario® Airtightness and Moisture Control System it offers a market leading solution in terms of thermal, acoustic and safety performance.

- ✓ **High performance** thermal insulation
- ✓ **Excellent acoustic performance**
- ✓ **A1 fire rating** highest rating on the market EN 13501-1
- ✓ **No slump** during installation and life of the system
- ✓ **Friction fits** in rafters eliminating any air gaps
- ✓ **Fully fill** Metac with our Vario® System
- ✓ **Vapour permeable insulation** for maximum protection from moisture and condensation issues
- ✓ **Excellent Indoor Air Quality** Eurofins Gold Comfort
- ✓ **Made from Recycled materials** up to 75% recycled glass



W/mK 0.031-0.034



*Where to use*

Residential

New and Old



# STANDARDS AND CERTIFICATION

|                            |   |
|----------------------------|---|
| <b>Quality</b>             | We hold a Quality Management Standard EN ISO 9001: 2015 for manufacturing.  |
| <b>CE</b>                  | All products are manufactured in accordance with the CE marking requirements under the Construction Products Regulation.  |
| <b>Product Standards</b>   | All products are manufactured in accordance with product standard: EN 13162:2012+A1:2015 and EN 13172 Evaluation of Conformity.   |
| <b>Environment</b>         | Isover is an ISO 14001:2015 (Environmental Management System) accredited manufacturing facility. This accreditation ensures that all products are manufactured to the stringent standards set out by this management system.  |
| <b>Indoor Air Quality</b>  | Awarded the highest standard in indoor air quality - Eurofins "Gold" Label The Gold Certificate means that Isover mineral wool is certified as an outstanding material in terms of Indoor Air Quality emissions regulations.  |
| <b>Durability</b>          | Fire Performance Euroclass classification of the product is related to the organic content, which cannot increase with time. Thermal conductivity of mineral wool products does not change with time, experience has shown the fibre structure to be stable and the porosity contains no other gases than atmospheric air. (See std EN13162:2012 Annex ZA,Table ZA.1) Will not accelerate corrosion with steel, copper or aluminium. Will not sustain vermin, nor breed or promote fungi or bacteria. |
| <b>Responsibly Sourced</b> | Our products have been manufactured to BES60001 to ensure their constituent materials have been responsibly sourced.  |



# CONTROL OF CONDENSATION AND VENTILATION

Isover complies with BS 5250:2016 code of practice for control of condensation in buildings & SR 82: 2017 Code of Practice for Slating and Tiling. These are the industry standards to ensure the building fabric is protected from moisture and condensation damage. This is achieved by ensuring adequate vapour control and ventilation measures are installed.

## Good Practice Details

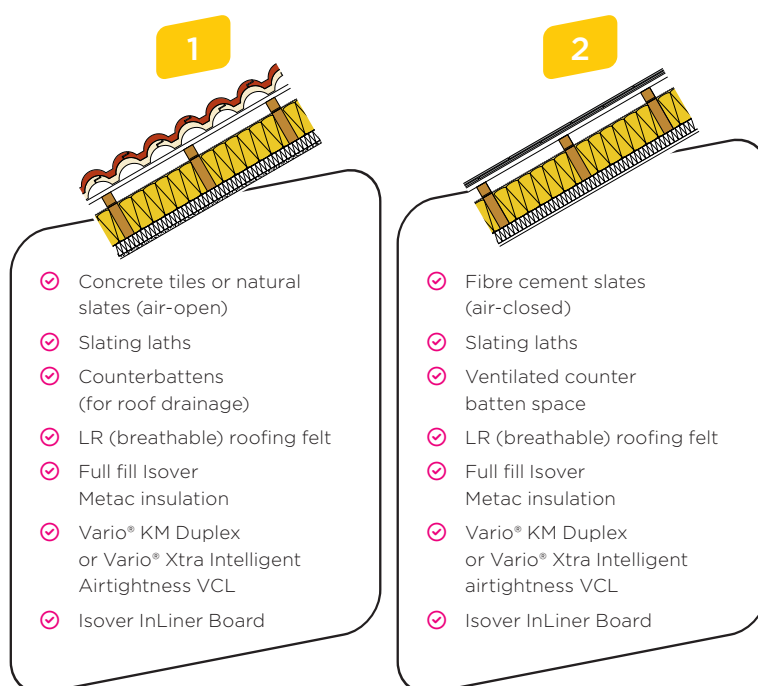

## The Standards Cover

- ✔ Dealing with high moisture levels and condensation to protect the building fabric.
- ✔ Ensuring a sufficiently permeable roof build up i.e. use of an adequate breathable roofing felt in conjunction with an air-open roof covering (e.g. natural slates or concrete tiles not fibre cement).
- ✔ Addressing the risks associated with excessive humidity in buildings, notably mould growth and condensation.
- ✔ Recommending best practice construction, counterbattens as above the roof membrane allows for better drainage of rain water and can accommodate ventilation under non-air-open coverings where ridge and eaves vents are provided over the felt.

### Isover Pitched Roof Solutions - How do they comply with these industry standards?

- Protecting Building Fabric - Managing moisture vapour.
- Healthy Indoor Air Quality - Dealing with mould growth and condensation.
- Energy Savings - Creating an airtight construction.
- Full Isover Solution - High performance mineral wool insulation and airtightness, moisture control.



*New Build U-Values:*

**0.16 Pitched Roof**

*Renovation U-Values:*

**0.25 Pitched Roof**

# BUILDING REGULATIONS REPUBLIC OF IRELAND

The following is a guide to thermal building regulations for new & existing dwellings, delivering comfort and energy savings through effective thermal insulation.

## Republic of Ireland

### New Dwellings TGD - Part L - 2019

Minimum standards for U-Values

Upper limit for air permeability is  $5\text{m}^3/(\text{h}\cdot\text{m}^2)$

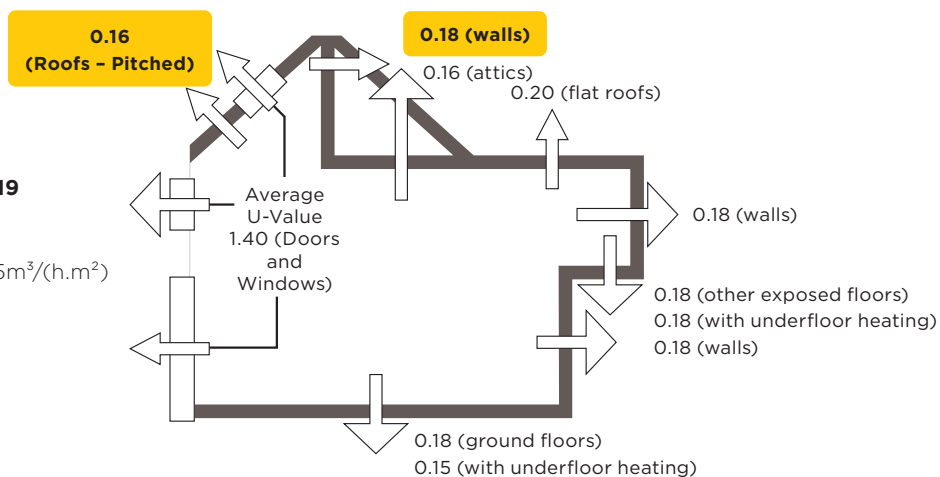

For more information you can contact our technical team on free phone (ROI) 1800 744480 or go to [www.isover.ie](http://www.isover.ie)

## Republic of Ireland

### Existing Dwellings TGD - Part L - 2019

Minimum standards for U-Values

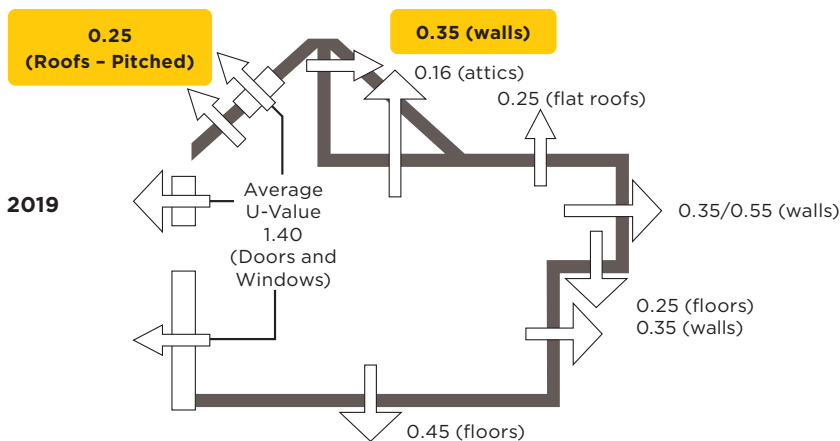

For more information you can contact our technical team on free phone (ROI) 1800 744480 or go to [www.isover.ie](http://www.isover.ie)



*Contact our technical team for more info*

**ROI**  
1800 744480

**NI**  
0845 399 0159

**EMAIL**  
[tech.ie@saint-gobain.com](mailto:tech.ie@saint-gobain.com)



*New Build U-Values:*

**0.20 Pitched Roof**

*Renovation U-Values:*

**0.18 Pitched Roof**

# BUILDING REGULATIONS NORTHERN IRELAND

The following is a guide to thermal building regulations for new & existing dwellings, delivering comfort and energy savings through effective thermal insulation.

**Northern Ireland**  
**New Dwellings - DFP Technical Booklet F1:2012**  
Minimum standards for U-Values  
Upper limit for air permeability is 10m<sup>3</sup>/(h.m<sup>2</sup>)

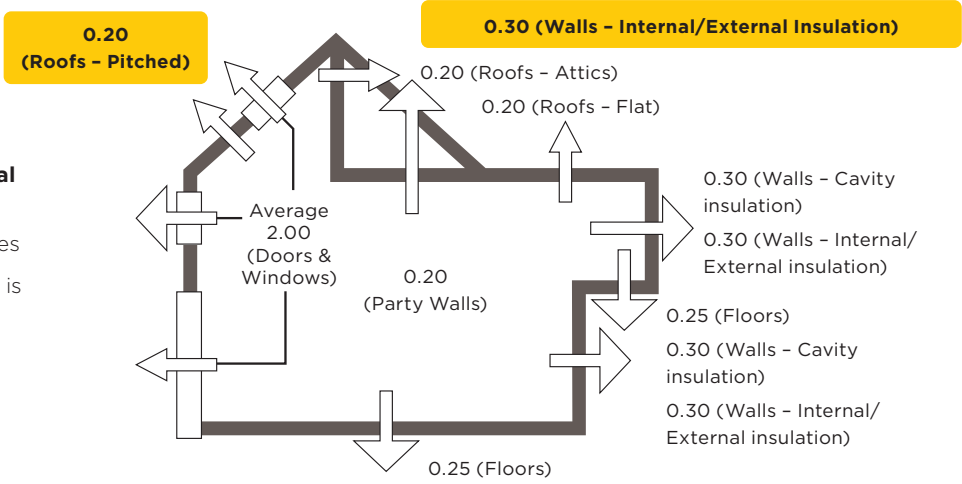

For more information you can contact our technical team on phone (NI) 0845 339 0159 or go to [www.isover.ie](http://www.isover.ie)

**Northern Ireland**  
**Existing Dwellings - DFP Technical Booklet F1:2012**  
Minimum standards for U-Values  
These regulations are split across new thermal elements added to an existing dwelling, for example a new extension or dormer & upgraded thermal elements within the existing building.

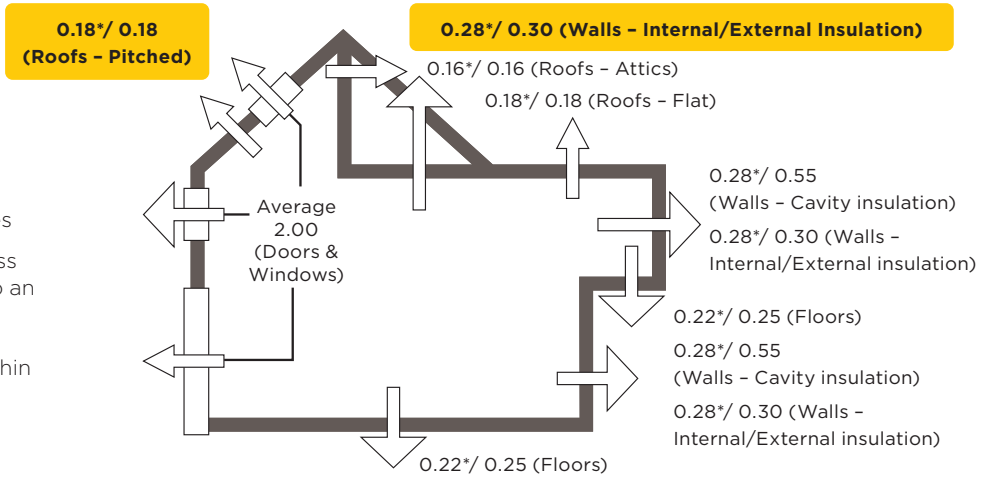

\*figures refer to a new element added to an existing dwelling i.e. extension, dormer etc.  
For more information you can contact our technical team on phone (NI) 0845 339 0159 or go to [www.isover.ie](http://www.isover.ie)



# FIRE PERFORMANCE IN TIMBER FRAME BUILDINGS

JULY 1ST 2017

## EN Standards instead of BS

As of July 1st 2017, new Building Regulations require fire protection of structural building elements in dwellings to be assessed under EN standards instead of British Standards (BS). The EN test uses a furnace that burns hotter/faster than the 'national' British Standard, BS 476 which means that building elements are subject to more onerous conditions and may need higher specifications as a result.

### Gyproc® plasterboard linings on example timer frame construction\*

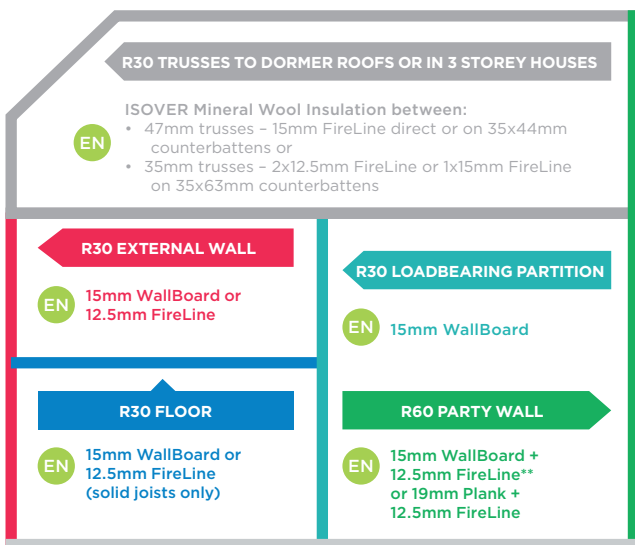

Supplementary Guidance to TGD B (Fire Safety) Vol 2, 2017. Issued Sept 2020.

### Guidance on Timber Frame Walls

“The build-up including linings must be carried out in the factory for all separating walls.”



An Roinn Tithíochta, Pleanála agus Rialtais Áitiúil  
Department of Housing, Planning and Local Government

\* This construction is specific to the relevant test evidence including loading, insulation, noggings, firestopping, fixing centres and counter battens. Designers must ensure the tested system is consistent with the built construction.

\*\*OSB sheathing to cavity.

Alternatives must be based on complete & relevant fire test evidence.

Visit the Technical Academy for our free courses on fire:  
[www.saint-gobain.ie/technical-academy/courses-cpds](http://www.saint-gobain.ie/technical-academy/courses-cpds)

For full system description, please refer to our Timber Frame Guide or contact the Saint-Gobain (Isover) Technical Department.



Free Phone (ROI): 1800 744480  
Free Phone (NI): 0845 3990159  
Email: [tech.ie@saint-gobain.com](mailto:tech.ie@saint-gobain.com)





TECHNICAL ACADEMY

With purpose built facilities, dedicated resources in Kingscourt and Dublin as well as NEW Online Training, Saint-Gobain Technical Academy offers a wide range of FREE training courses and webinars to upskill and educate construction industry professionals.

The mix of interactive training, live demo and theory courses include:

- Airtightness and moisture management
- Acoustics in Buildings
- Dry lining systems for installers and supervisors
- nZEB in Practice
- Fire performance in buildings
- Renovation solutions
- ROI Building Regulations & Compliance
- Internally insulating existing external walls: The challenges faced and a possible solution

...and much more

Sign up for our NEW Online Training Courses at

[www.saint-gobain.ie](http://www.saint-gobain.ie)



REGISTER NOW

Sign Up  
TODAY!

# Get the know-how with the Saint-Gobain Technical Academy



  
SAINT-GOBAIN



If renovating or converting your attic, Isover Metac easily exceeds renovation regulations!

# PITCHED ROOFS

## Pitched Roof insulation full filled between rafters + Vario®

1. Tiled or slated roof with external counter battens/ventilation space\*
2. Low resistance Underlay per BS 5250
3. Isover insulation installed between rafters
4. Vario® System
5. Gyproc WallBoard

Isover Metac is a high performance mineral wool insulation 'slab on a roll'. When used in conjunction with our Vario® Airtightness and Moisture Control System it offers a market leading solution in terms of thermal, acoustic and safety performance. If also combined with Isover InLiner Board you have the complete mineral wool pitched roof solution. Isover InLiner Board is a super dense, rigid and high performance laminated Insulated Plasterboard.

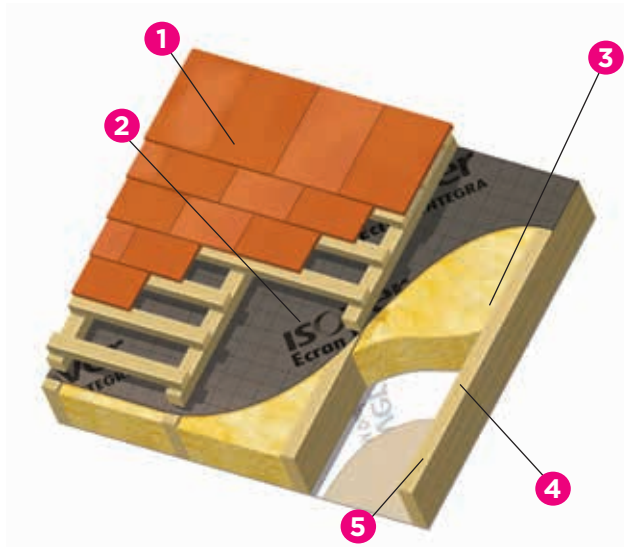

| Insulation in rafters (mm)  | Airtightness/<br>Moisture Control | Board lining            | U-value<br>W/m <sup>2</sup> K<br>for 400<br>centres | U-value<br>W/m <sup>2</sup> K<br>for 600<br>centres |
|-----------------------------|-----------------------------------|-------------------------|---|---|
| Metac 031 180mm             | Vario® System                     | 12.5mm Gyproc WallBoard | 0.21  | 0.19  |
| Metac 034 220mm             | Vario® System                     | 12.5mm Gyproc WallBoard | 0.18  | 0.17  |
| Metac 034 150mm x 2         | Vario® System                     | 12.5mm Gyproc WallBoard | 0.14  | 0.13  |
| Metac 031 140mm & 034 150mm | Vario® System                     | 12.5mm Gyproc WallBoard | 0.14  | 0.13  |

Any values are indicative, please contact our technical support team for values pertaining to your project.

### Isover Products



Metac Roll



Vario® System



## Application CAD Details

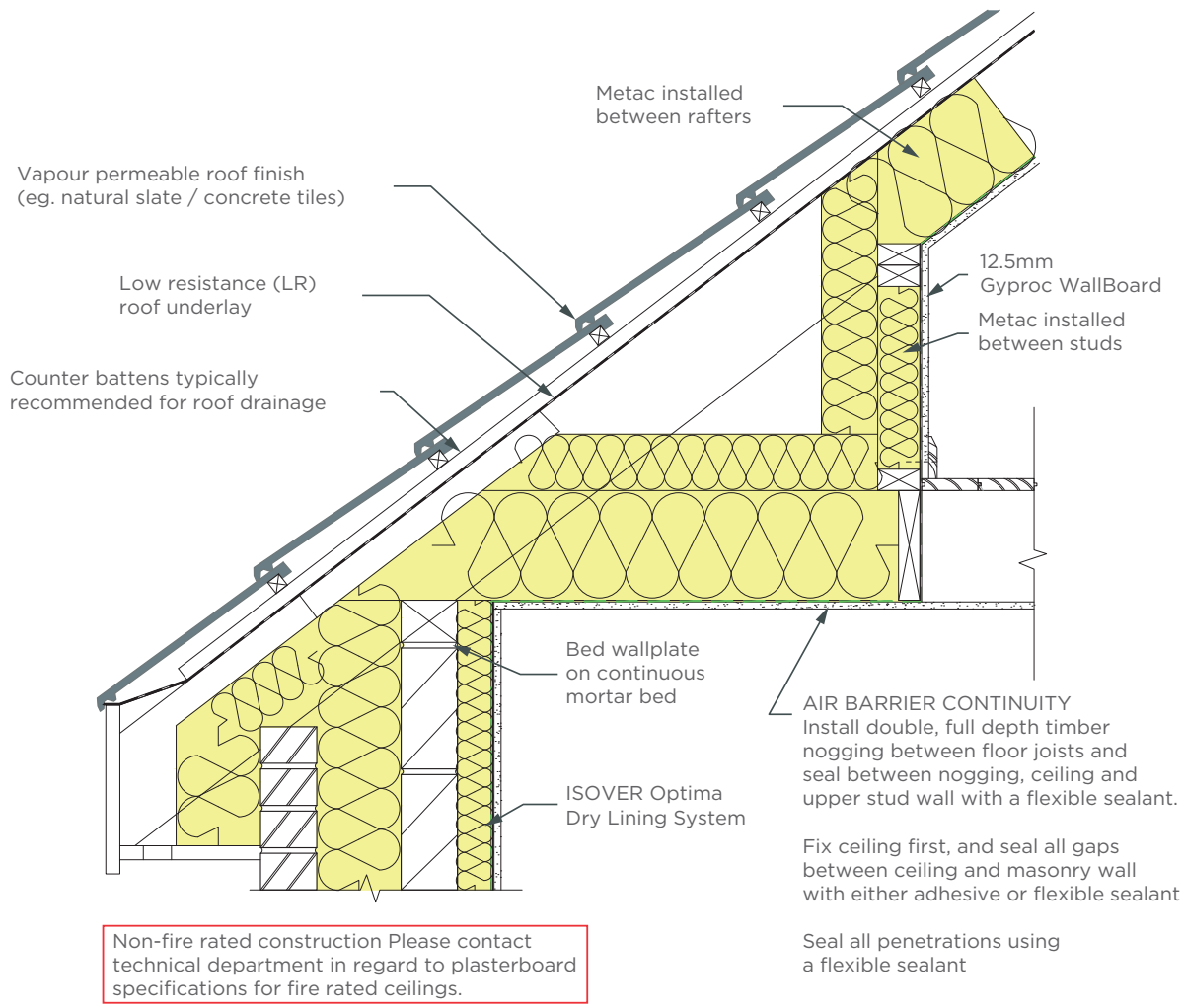

**Note:** Not all standard construction details are shown on this drawing. If unsure about any detail check with site engineer.



*Contact our technical team for more info*

**ROI**  
1800 744480

**NI**  
0845 399 0159

**EMAIL**  
tech.ie@saint-gobain.com



# PITCHED ROOF WITH INTERNAL COUNTER BATTENS

## Insulation full filled between rafters + Vario® + internal counter battens

1. Tiled/natural slate roof tiling battens or counter battens where required
2. Low resistance underlay
3. Isover Metac Insulation friction fit between rafters
4. Isover Vario® membrane and tapes applied under the rafters
5. Isover insulation between 50mm counter battens
6. Gyproc plasterboard as specified in the performance tables

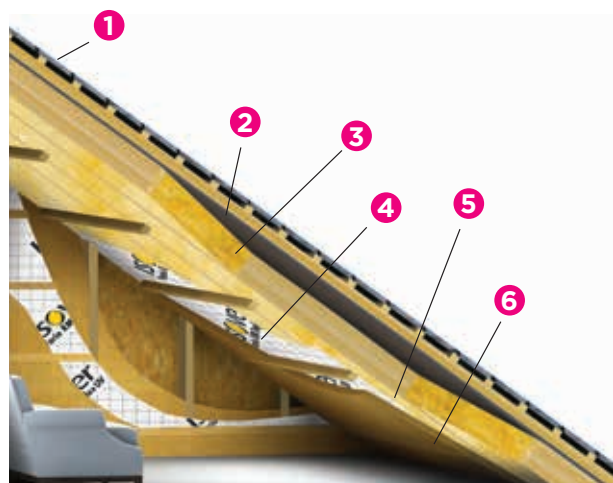

| Truss width (min.) | Gyproc Plasterboard Type | Airtightness Layer | Rafter Depth | Insulation in Rafters | Insulation below rafters | Secondary framing below rafters | Noggings* c/c | U Value 600mm c/c | U Value 400mm c/c |
|--------------------|--------------------------|--------------------|--------------|-----------------------|--------------------------|---------------------------------|---------------|-------------------|-------------------|
|--------------------|--------------------------|--------------------|--------------|-----------------------|--------------------------|---------------------------------|---------------|-------------------|-------------------|

**30 Minutes Fire Resistance (Typically 3 storey dwellings, as well as 2 storey attic spaces intended for conversion to habitable spaces, and 2 storey dwellings with Dormer Truss Roofs)**

|      |                     |                          |       |                     |                |  |               |      |      |
|------|---------------------|--------------------------|-------|---------------------|----------------|--|---------------|------|------|
| 47mm | 1 x 15mm FireLine   | Vario® KM Duplex & Tapes | 175mm | Metac 031 180mm     | Metac 034 50mm | 50 x 44mm counter battens                              | Not required  | 0.16 | 0.17 |
| 47mm | 1 x 15mm FireLine   | Vario® KM Duplex & Tapes | 175mm | Metac 031 180mm     | Metac 034 50mm | As required for insulation                             | 35x63mm (min) | 0.16 | 0.18 |
| 47mm | 1 x 15mm FireLine   | Vario® KM Duplex & Tapes | 200mm | Metac 034 2 x 100mm | Metac 034 50mm | 35 x 63mm counter battens                              | 35x63mm (min) | 0.15 | 0.17 |
| 47mm | 2 x 12.5mm FireLine | Vario® KM Duplex & Tapes | 200mm | Metac 031 180mm     | Metac 034 50mm | As required for insulation + 35 x 44mm service battens | Not required  | 0.15 | 0.16 |
| 35mm | 2 x 12.5mm FireLine | Vario® KM Duplex & Tapes | 200mm | Metac 034 2 x 100mm | Metac 034 50mm | As required for insulation + 35 x 44mm service battens | Not required  | 0.15 | 0.16 |

\*Timber noggings of the minimum size stated are required to maintain support and fixing grounds to all plasterboard edges, both around the perimeter and in the field of the installed ceiling below rafters.

### Isover Products



Metac Roll



Vario® System



Comfort Roll 35



## Application CAD Details

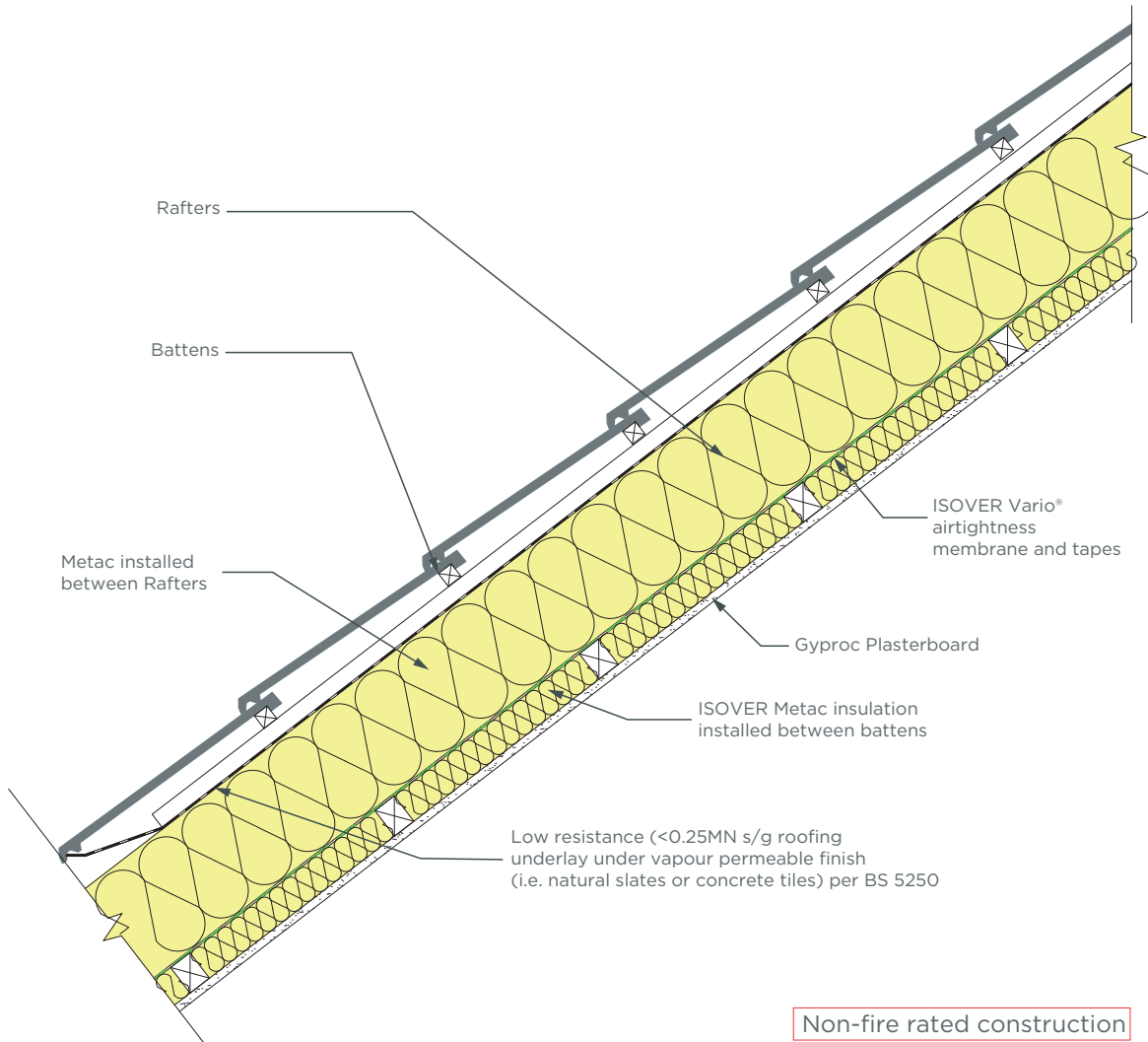

**Note:**

Not all standard construction details are shown on this drawing. If unsure about any detail check with site engineer.



Contact our technical team for more info

**ROI**  
1800 744480

**NI**  
0845 399 0159

**EMAIL**  
tech.ie@saint-gobain.com





# INSTALLATION PITCHED ROOF WITH COUNTER BATTENS

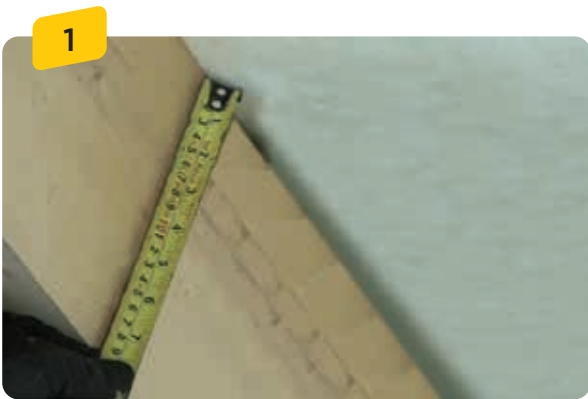

Measure depth and width of rafters. Then measure the length and width of the building and multiply twice the span of the rafters by the length of the building.



Lift Metac into the attic still in its packaging.

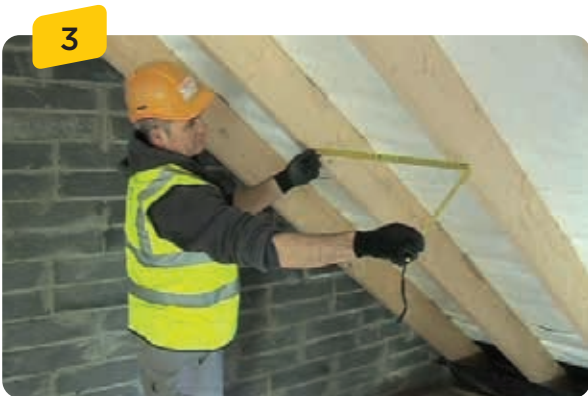

Measure and cut the roll to fit rafter width leaving 10mm extra on dimension.



Unroll and allow full recovery, use a straight edge and sharp insulation knife. Push and friction fit the insulation between the rafters.



Want to know more?

Watch our install videos



[www.youtube.com/isoverireland](http://www.youtube.com/isoverireland)

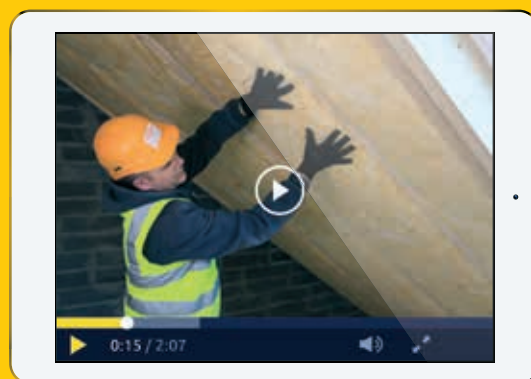

5



When rafters have had insulation installed, proceed to install membrane and counter battens. Ensure eaves ventilation is left where required. Metac can be fully filled between rafters when used with our Vario® Xtra membrane installed below the insulation.

6



To increase the U-value, Isover recommends installing 50 x 50mm counter battens filled with 50mm Metac - this allows a service zone without need to pierce airtight membrane.

7



Push and friction fit between counter battens,

8



Finally use Gyproc plasterboard applied to counter battens to complete the installation. This combined with our Vario® Membrane and Metac, provides the safest solution to protect timber rafters from moisture damage.



# ISOVER METAC ROLL 031

For use in Pitched roof attics • Pitched roof rafters  
• Walls internally insulated



## Product Features

1. Thermal conductivity 0.031 W/mK
2. Excellent acoustic performance
3. Excellent fire safety - A1 fire rated
4. Vapour permeable breathable insulation
5. Improves energy performance and reduces heating & cooling costs
6. Easy to install. Friction fits between timber stud, joists and rafters with no need for additional fixings
7. Made from recycled glass. Minimal manufacturing and on-site wastage. Low carbon footprint at manufacture and during transport



An extra high performance quality thermal insulation roll designed for a wide range of applications where space is at a premium.



**Our Best Mineral Wool Roll**  
W/mK 0.031

| Product      | Order Code | Thickness (mm) | Width (mm) | Length (mm) | Pack Area (m2) | Pack Per Pallet |
|--------------|------------|----------------|------------|-------------|----------------|-----------------|
| Isover Metac | 5200899796 | 90             | 1200       | 5400        | 6.24           | 18              |
| Isover Metac | 5200841098 | 140            | 2 x 600    | 3500        | 4.2            | 18              |
| Isover Metac | 5200861944 | 140            | 3 x 400    | 3400        | 4.08           | 18              |
| Isover Metac | 5200868092 | 180            | 1250       | 2700        | 3.375          | 18              |

*Where to use*





Pitched roof rafters



Walls internally insulated





# ISOVER METAC ROLL 034

For use in Pitched roof attics • Pitched roof rafters  
• Walls internally insulated



## Product Features

1. Thermal conductivity 0.034 W/mK
2. Excellent acoustic performance
3. Excellent fire safety - A1 fire rated
4. Vapour permeable breathable insulation
5. Improves energy performance and reduces heating & cooling costs
6. Easy to install. Friction fits between timber stud, joists and rafters with no need for additional fixings
7. Made from recycled glass. Minimal manufacturing and on-site wastage. Low carbon footprint at manufacture and during transport



A high performance quality thermal insulation roll designed for a wide range of applications where space is at a premium.



W/mK 0.034

| Product      | Lambda Value | Product Code | Thickness (mm) | Width (mm) | Length (mm) | Roll Area (m <sup>2</sup> ) | Rolls Per Pallet |
|--------------|--------------|--------------|----------------|------------|-------------|-----------------------------|------------------|
| Isover Metac | 0.034        | 5200771695   | 50             | 1200       | 9300        | 11.16                       | 18               |
| Isover Metac | 0.034        | 5200771696   | 100            | 1200       | 6000        | 7.20                        | 18               |
| Isover Metac | 0.034        | 5200765192   | 150            | 1200       | 4100        | 4.92                        | 18               |
| Isover Metac | 0.034        | 5200771700   | 150            | 3 × 400    | 4100        | 4.92                        | 18               |
| Isover Metac | 0.034        | 5200771705   | 180            | 1200       | 3400        | 4.08                        | 18               |
| Isover Metac | 0.034        | 5200771708   | 180            | 3 × 400    | 3400        | 4.08                        | 18               |
| Isover Metac | 0.034        | 5200765193   | 220            | 1200       | 2900        | 3.48                        | 18               |
| Isover Metac | 0.034        | 5200852270   | 220            | 3 × 400    | 2900        | 3.48                        | 18               |

Any values are indicative, please contact our technical support team for values pertaining to your project.







**Isover Ireland**

Unit 4, Kilcarbery Business Park,  
Nangor Road, Dublin 22  
D22 R2Y7  
Telephone: 01 629 8400  
Email: [info@isover.ie](mailto:info@isover.ie)  
[www.isover.ie](http://www.isover.ie)



@SaintGobainGroup



Saint-Gobain



@saintgobain

Gyproc, Gypframe and Glasroc are all registered trade names of Saint-Gobain Construction Products (Irl) Limited. Isover is a registered trade name of Saint-Gobain. Saint-Gobain Construction Products (Irl) Limited reserves the right to revise product specifications without notice. The information in this document was correct to the best of our knowledge at the time of publication. It is the user's responsibility to ensure that it remains current prior to use. The information in this document is for guidance only and should not be read in isolation. Users should read and familiarise themselves with all the information contained in this document and ensure that they are fully conversant with the products and systems being used, before subsequent specification or installation. For a comprehensive and up-to-date library of information visit the Isover website at: [www.isover.ie](http://www.isover.ie)