

TRITON

RETROFIT KIT

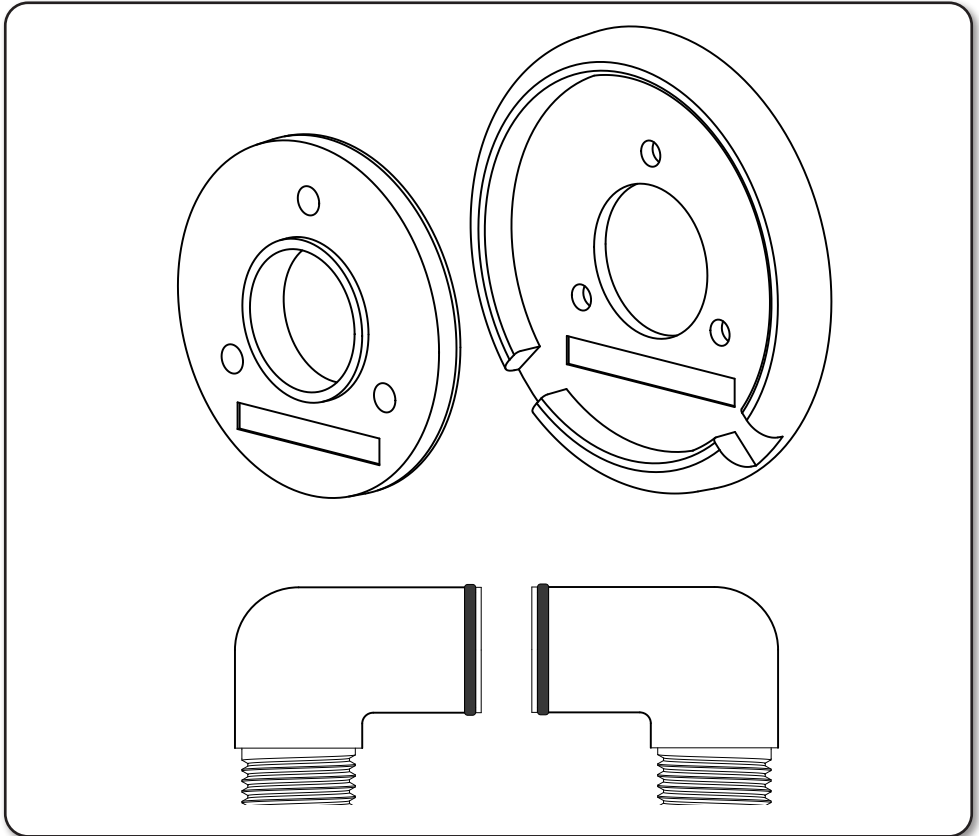

Installation Instructions

INSTALLERS PLEASE NOTE THESE INSTRUCTIONS ARE TO BE LEFT WITH THE USER

2181669A - May 2022

INTRODUCTION

When replacing Triton valve 86004410 please use this Retrofit Kit 86006140. This kit may help when replacing other valves, however, this is outside the scope of this instruction.

Please read these instructions carefully and read through the whole of this guide before beginning your installation.

The installation must be carried out by a suitably competent person and in the sequence of the instruction book.

NOTE: Only basic installation options have been listed. All other installation options are beyond the scope of this guide.

Refer to your mixer installation guide for further information.

To check the product suitability for commercial and multiple installations, please contact Triton's specification advisory service before installation.

Telephone: 024 7637 2222

E mail: technical@tritonshowers.co.uk

INSTALLATION

Remove the existing valve and brass mounting plate from the wall.

Using the new brass mounting plate, mark the position of the fixing holes (**fig.1**). Ensure it is central to the pipework and at the correct height for the valve to connect to the pipes.

Before drilling, check that the holes will line up correctly when the mounting plate is assembled with the spacer (if required) and trim as shown in **fig.4**

Drill and plug the wall (**fig.2**).

Measure the height of the elbow from the existing valve (**fig.3a**).

If the elbow measures **more** than 40mm, assemble the retrofit kit as shown in **fig.3b**.

If it measures **less** than 40mm, assemble as shown in **fig.3c**.

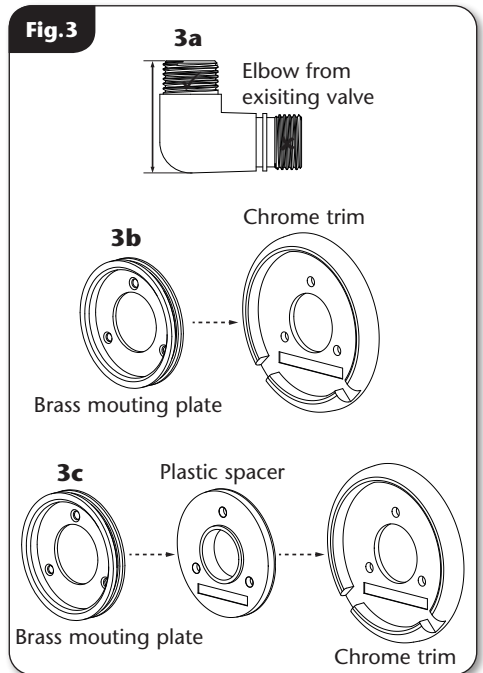
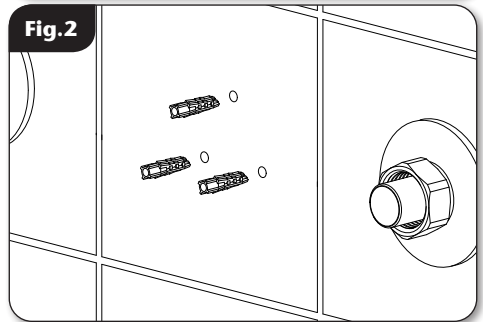
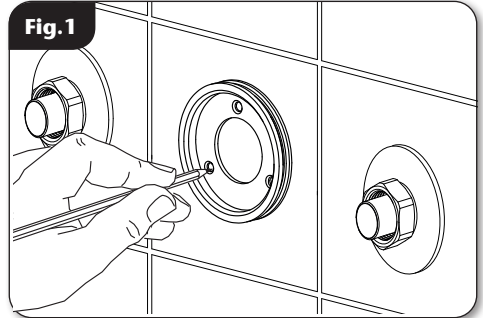

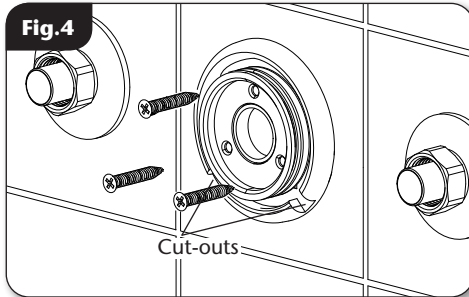

Ensure the cut-outs on the chrome trim are at the bottom and fix the kit to the wall using suitable screws (**fig.4**).

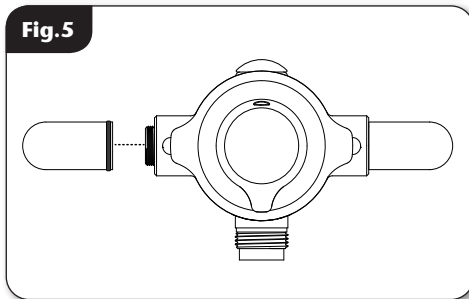

Remove the elbows from the new valve and replace with the retrofit elbows (**fig.5**). Rotate to adjust the position to match the pipework.

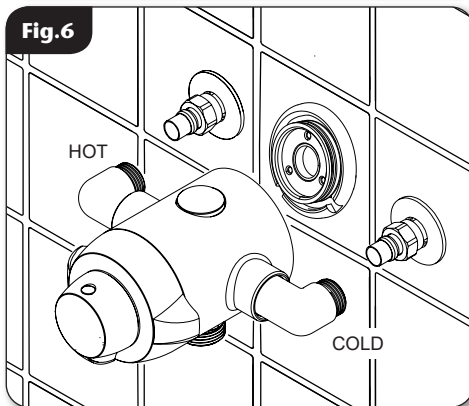

Connect the hot water supply to the inlet marked **HOT**, 'H' or red/orange label and connect the cold water supply to the inlet marked **COLD**, 'C' or blue label (**fig.6**).

Tighten the nuts.

Tighten the grub screws underneath the valve to secure it to the mounting plate.

Carry out the commissioning process detailed in the valve installation guide.

Triton Showers
Triton Road
Nuneaton
Warwickshire CV11 4NR

Triton is a division of Norcros Group (Holdings) Limited

Customer Experience: 024 7637 2222

Trade Installer Hotline: 024 7637 8344

www.tritonshowers.co.uk

E-mail: serviceenquiries@tritonshowers.co.uk

technical@tritonshowers.co.uk

For product guarantee information please go to www.tritonshowers.co.uk/product-guarantees

TRITON reserve the right to change product specification without prior notice. E&OE. © TRITON SHOWERS 2022